

OCULUS DISASSEMBLY

WARNING! Before disassembling your Oculus22™, first remove the magazine and check the chamber of the firearm to confirm that it is in a safe condition and completely unloaded. Do not disassemble your Oculus22 while the suppressor is attached to the host firearm. Remove the suppressor before disassembly. Failure to do so could result in serious personal injury or death.

CAUTION! Do NOT use a vise, pliers, or tools other than outlined in this manual on your suppressor.

OCULUS22™ DISASSEMBLY

1. After removing the magazine of your firearm and checking the chamber of the firearm to confirm that it is in a safe condition and completely unloaded, remove the Oculus22 from the host firearm.
2. Remove the ADAPT Module from the main suppressor body by unscrewing it counter-clockwise.
3. Remove the baffle stack from the main suppressor body by pushing forward on the baffle cone from inside the mount with your finger or a wooden dowel rod.
4. Remove the front cap from the ADAPT Module using the provided disassembly tool.
5. Remove the baffle stack from the ADAPT Module by pushing forward on the baffle cone from the externally threaded end towards the front cap end with your finger or a wooden dowel rod.
6. Break the baffles apart one at a time. If the baffles are stuck together, a hex key can be used as a tool to aid in disassembly. Insert the long end of the key into the baffle port and GENTLY pry against the inside of the baffle to release it.

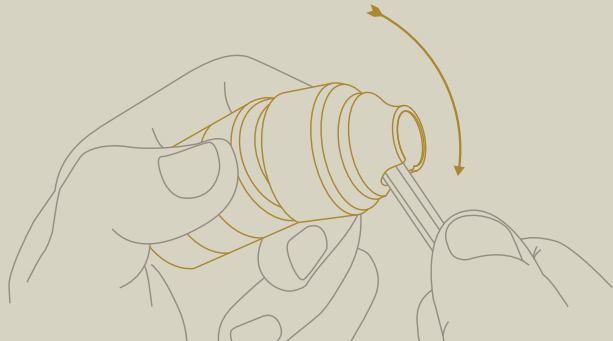

BAFFLE STACK ASSEMBLY

WARNING! Never attempt to remove a hot suppressor without the proper protective gear. Allow the suppressor to cool before removal. Failure to do so could result in serious personal injury or death.

WARNING! Never allow a hot suppressor to come into contact with anything. Allowing a hot suppressor to come in contact with anything could result in fire, serious personal injury or death.

WARNING! Before installation of the Oculus22™ suppressor, remove the magazine and check the chamber of the firearm to confirm that it is in a safe condition and completely unloaded. Failure to do so could result in serious personal injury or death.

WARNING! Before installation of the Oculus22 suppressor, check the bore of the suppressor to make sure it's free of any obstructions. Failure to do so could result in serious personal injury or death.

MAIN BAFFLE STACK ASSEMBLY

The main baffle stack consists of 5 baffles—1 blast baffle, 3 standard baffles and 1 short baffle.

1. Start by placing the short baffle on a flat, level surface with the cone facing up.
2. Place a standard baffle on top of the short baffle with the ports aligned. Each baffle will index with one another with the indexing tabs machined to each mounting surface.
3. Assemble the remaining standard baffles to the stack.
4. The last baffle will be the blast baffle. It is easily identified by a “#1” engraved on its body.
5. Once the main baffle stack is fully assembled, check for any spacing between the baffles. If a space is present, a rubber mallet can be used to fully seat each baffle.

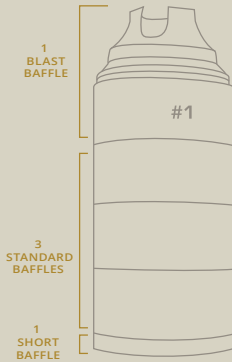

6. Insert the baffle stack into the main suppressor body with the #1 baffle cone facing down.

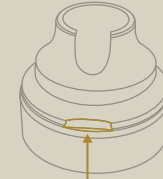

INDEXING TAB

Each baffle has indexing tabs for easy assembly.

7. Align the indexing tabs in the blast baffle with the indexing flats on the inside of the main suppressor body. There will be an audible “click” when the baffle stack is correctly seated. Aligning the port side indexing tab on the baffle with the same indexing flat on the suppressor body each time will ensure minimal point of impact shift from disassembly. The Oculus22™ serial number is engraved over an indexing tab to aid in repeatable alignment of the baffle stack.

ADAPT™ MODULE ASSEMBLY

WARNING! Before removal or installation of your Oculus22™ ADAPT Module, first remove the magazine and check the chamber of the firearm to confirm that it is in a safe condition and completely unloaded. Failure to do so could result in serious personal injury or death.

WARNING! Never attempt to remove your Oculus22 ADAPT Module while the suppressor is hot without the proper protective gear. Allow the suppressor to cool before removal.

When changing between the short and long configurations; make sure the suppressor body has cooled to ambient temperatures before attaching/detaching the ADAPT™ Module.

ADAPT MODULE REMOVAL

1. To remove the ADAPT Module, first remove the muzzle cap from the end of the Module by utilizing the provided disassembly tool and rotating counter-clockwise until removed.
2. With the muzzle cap removed, hold the suppressor body with one hand and rotate the Module counter-clockwise until removed.

ADAPT™ MODULE ASSEMBLY

The ADAPT Module baffle stack contains 5 baffles—4 standard baffles and 1 short baffle.

1. First, thread the empty ADAPT Module onto the main suppressor body. The suppressor body should already contain the main baffle stack. Check to see the gap between the main body of the suppressor and the ADAPT module is correct by referring to “Figure A” on the reverse side.
2. Start the baffle assembly by placing the short baffle on a flat, level surface with the cone facing up.
3. Place a standard baffle on top of the short baffle with the ports aligned. Each baffle will index with one another with the indexing tab that is machined to each surface.
4. Continue assembling the remaining three ADAPT Module baffles.
5. Attach the ADAPT Module tube to the main body.
6. Insert the assembled ADAPT Module baffle stack into the tube. As the end cap seats into the baffle stack, and may cause the stack to rotate slightly, it may be necessary to align the ADAPT Module ports approximately 1/8 of a turn to counter-clockwise of the suppressor body baffle stack ports to ensure correct alignment when fully assembled.
7. Screw on the front cap using the provided tool. Tightening will seat the front cap into the last baffle.

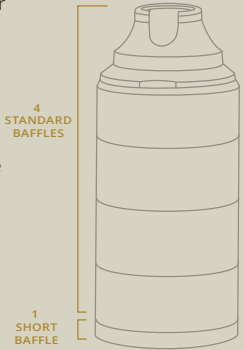

*****It is important to make sure the ADAPT Module and main tube baffle ports are in alignment for maximum performance of your suppressor.*****

WARNING! While suppressors reduce the sound impulse of a gun shot they do not eliminate the impulse all together. It is still necessary for the shooter and any bystanders to wear OSHA approved hearing protection when exposed to impulses over 85db.

MOUNTING SYSTEM

WARNING! Before installation of the Oculus22™ suppressor to your host weapon, remove the magazine and check the chamber of the firearm to confirm that it is in a safe condition and completely unloaded. Failure to do so could result in serious personal injury or death.

WARNING! Since thread mounted suppressors may unscrew during firing, it is extremely important that the operator ensures the suppressor remains securely threaded to the barrel. The threading of the suppressor to the host firearm should be checked in between magazines AFTER first ensuring that the firearm is unloaded.

MOUNTING TO YOUR HOST FIREARM

For proper bore alignment, it is important that the suppressor is threaded against a 90-degree barrel shoulder. During any of the installation steps, if the suppressor becomes tight before firmly seating against the shoulder of the barrel or if it still feels loose after seating against the shoulder, STOP and contact Rugged Suppressors.

WARNING! Never allow a hot suppressor to come into contact with anything. Allowing a hot suppressor to come in contact with anything could result in fire, serious personal injury or death.

Figure A

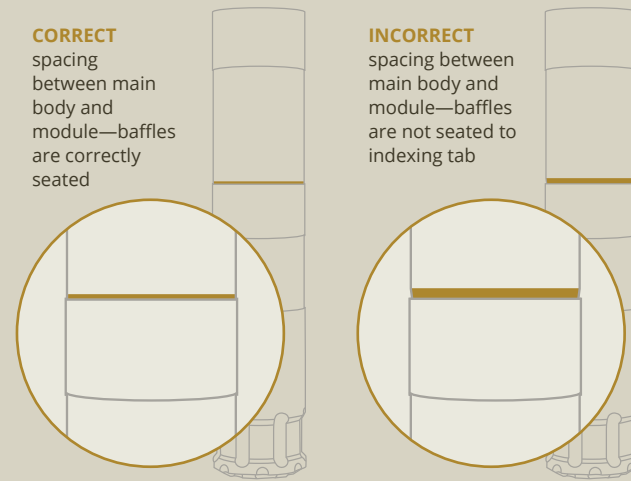

**UNCONDITIONAL
LIFETIME
WARRANTY**

IF FOR ANY REASON YOU HAVE AN ISSUE WITH A RUGGED SUPPRESSORS PRODUCT, WE WILL REPAIR OR REPLACE IT FREE OF CHARGE.



OCULUS 22™

OPERATOR'S MANUAL

** WARNING **

Read the operator's manual in its entirety before use. Failure to follow all operating instructions, assembly and disassembly, installation, cleaning and maintenance instructions before using the suppressor could result in serious injury or death. If you are at all unsure about any of the operations or instructions outlined in the operator's manual, STOP and CONTACT US for further clarification.

SERVICE/MAINTENANCE

WARNING! Always wear proper protective equipment while performing service/maintenance. Failure to do so could result in serious personal injury or death.

WARNING! Before performing service/maintenance on the suppressor, remove the magazine and check the chamber of the host weapon to confirm that it is in a safe condition and completely unloaded, then remove the suppressor from the host weapon. Never attempt to clean a suppressor while it is attached to a host weapon. Failure to do so could result in serious personal injury or death.

WARNING! Discharging firearms in poorly ventilated areas or cleaning suppressors may result in exposure to lead and other substances known to cause birth defects, reproductive harm, and other serious physical injury. Have adequate ventilation at all times. Wash hands thoroughly after exposure.

OCULUS CLEANING

Rugged Suppressors recommends cleaning of the disassembled baffles with an ultrasonic cleaner using a 50/50 mixture of Purple Power® and water. Allow the baffles to be cleaned for approximately 1 hour, remove the parts and allow to dry. There may be some carbon residue remaining on the parts after ultrasonic cleaning. You can continue cleaning these with a brush and cleaning solution if you desire; however, it is not necessary. The inside of the suppressor tube can be cleaned using normal gun solvent and cleaning techniques. We recommend using a 12 gauge bore brush and a brass wire brush to remove any carbon as necessary.

VISIT US AT RUGGEDSUPPRESSORS.COM
864-810-0513 | INFO@RUGGEDSUPPRESSORS.COM
MADE IN USA

